

Welcome to the Kwikset family!

This guide will get you ready to install your handleset.

If you have any issues, please visit our support center: kwikset.com/support or call us at 1-800-327-5625.

Installation and Reference Guide

This manual can be used to install a variety of handlesets.

Recommended Tools

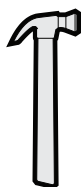

wood block



*Tools will depend on install type

[Door Prep:](#) If you need help in preparing your door

[Drilling template:](#) If you need help in drilling your door

Screw Reference

Latches and Strikes

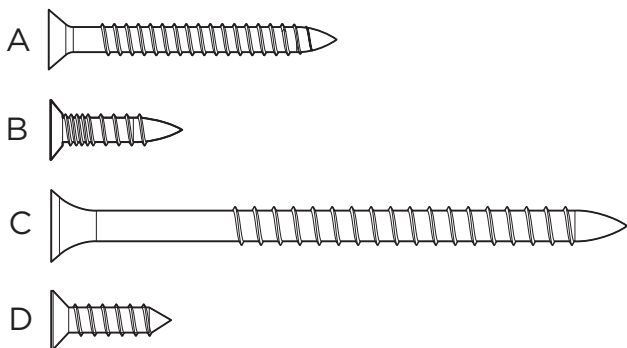

Deadbolt and Handleset

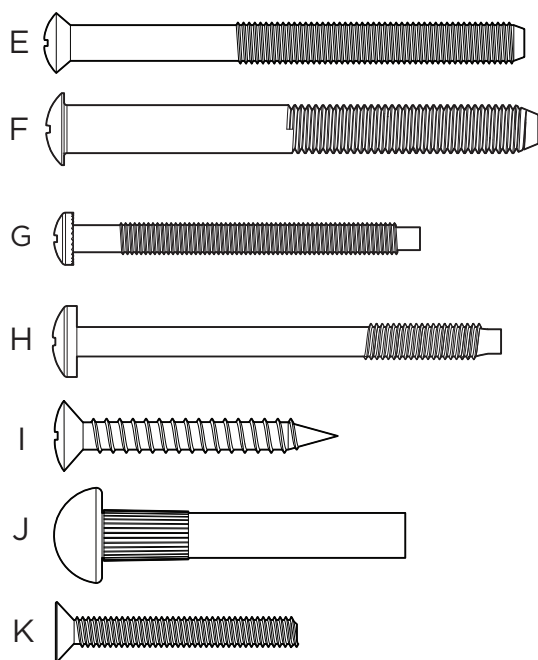

Levers and Knobs

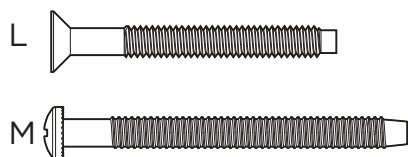

1 Adjust backset of the top latch (if needed)

- A Hold the latch in front of the door hole, with the latch case flush against the door edge.

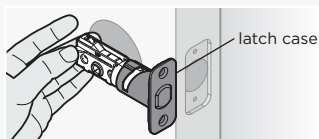

- B If the D-shaped hole is centered in the door hole, no adjustment is required. Proceed to step 2.

If the D-shaped hole is NOT centered, adjust latch. See "Latch Adjustment" (step 1C).

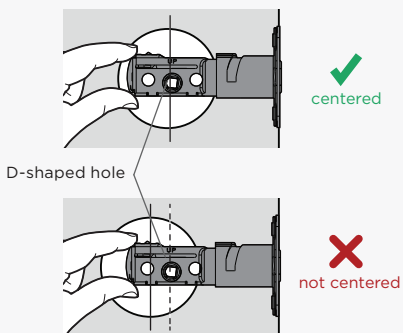

- C Latch Adjustment (only if needed)

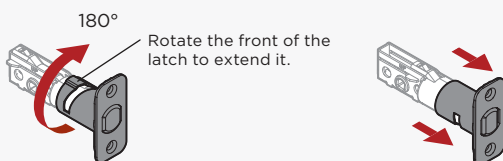

2 Install top latch

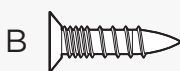
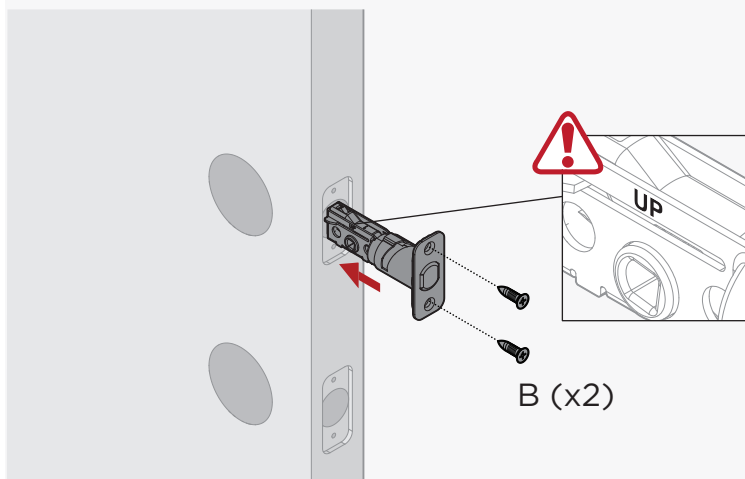

3 Adjust backset of the bottom latch (if needed)

- A Hold the latch in front of the door hole, with the latch face flush against the door edge.



- B If the semicircular hole is centered in the door hole, no adjustment is required. Proceed to step 4.

If the semicircular hole is NOT centered, adjust latch. See "Latch Adjustment" (step 3C).

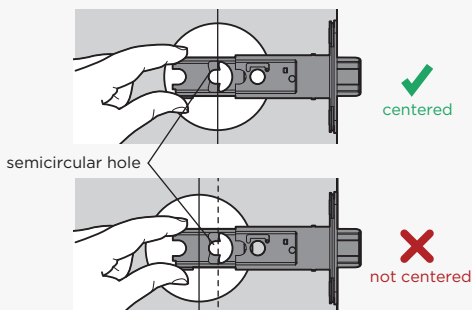

- C Latch Adjustment (if needed)

Grasp the pin on both sides of the latch and move it to the longer setting.

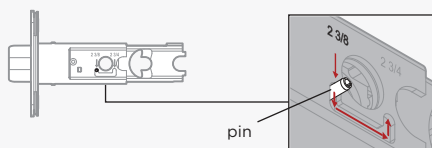

4 Install bottom latch

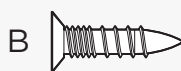
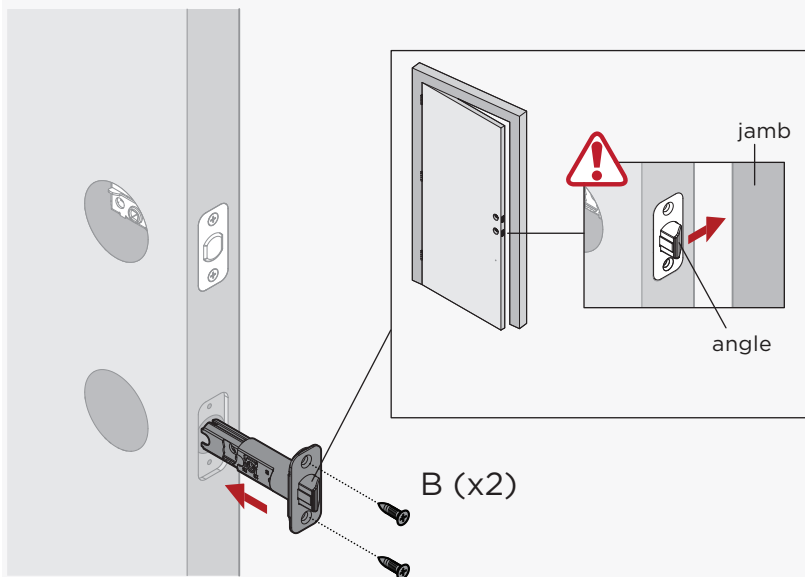



Installation instructions differ by handleset design.

For installation instruction for the below design,
follow directions on [page 6](#).



For installation instruction for the below design,
follow directions on [page 9](#).



For installation instruction for the below design,
follow directions on [page 12](#).



Installation instruction for the below designs.



5 Determine deadbolt mounting screws

Measure the thickness of your door to determine the required mounting screws for step 6.

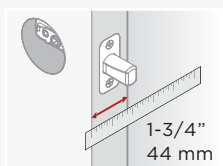

or

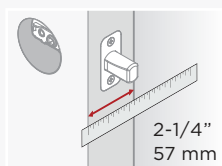

E (2x)

Call Kwikset to order a service kit for 2-1/4" (57 mm) thick doors. Use the screws provided in the kit.

6 Install deadbolt

A

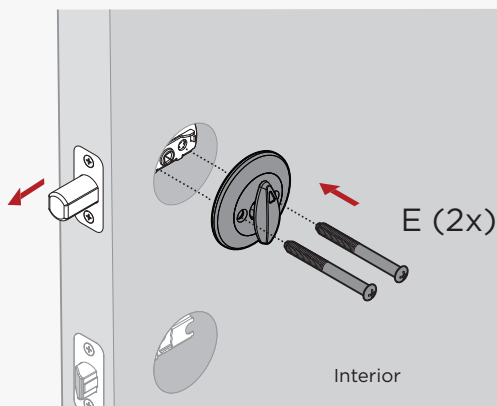

7 Install handleset

A

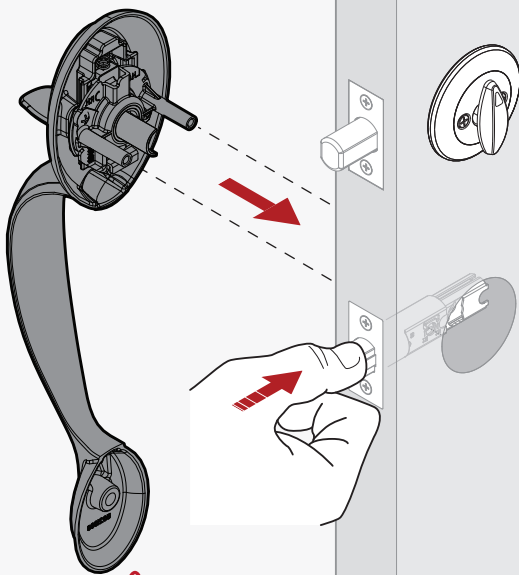

Press latch bolt in to insert the spindle. Insert the spindle into the semicircular hole in the bottom latch, and insert the bottom post through the bottom hole in the door.



If adjustment is required, pull and rotate spindle.

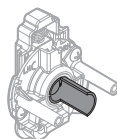
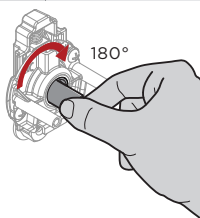
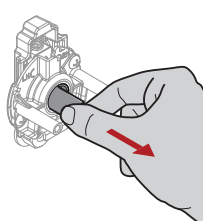

B

Wood door

or

Metal door

If hole is drilled only partway through the door, use screw "I".



If hole is drilled all the way through wood door, use screws "J" and "K".

J



K

J



K

I

J

K

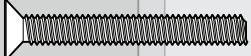
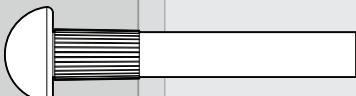
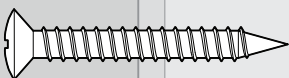

8 Install lever or knob

Option 1: Visible Screws

M



or

Option 2: Hidden Screws

M



A

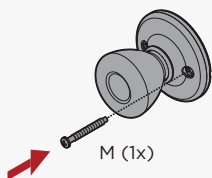

A

Loosen pre-installed set screws



B

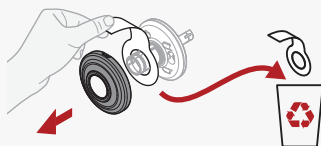

B

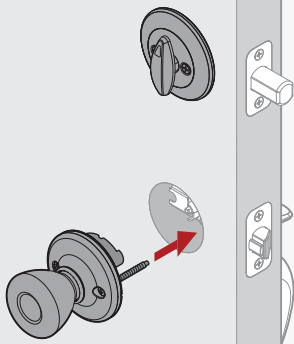

C

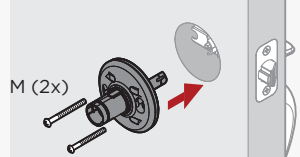

D



C

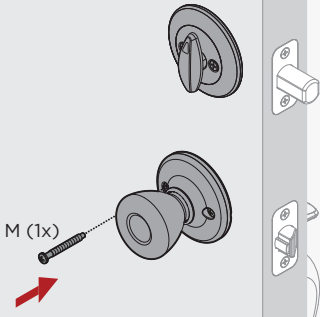

E

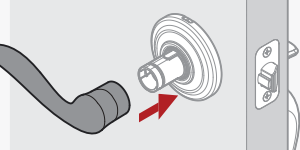

F

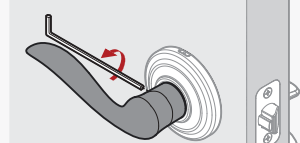

9 Install strike on door frame

A

Jamb

A (x2)



A (x2)



A



B

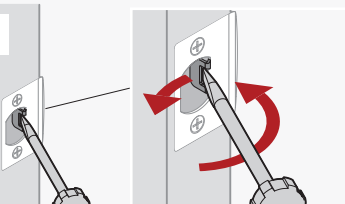

Close door and test handleset operation. If latch is loose in the strike, adjust the strike tab so it grips the latch better when the door is closed.

Installation instruction for the below designs



10 Determine deadbolt mounting screws

Measure the thickness of your door to determine the required mounting screws for step 11.

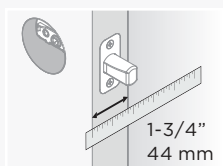

or

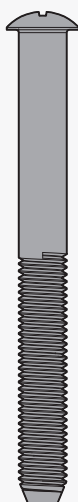
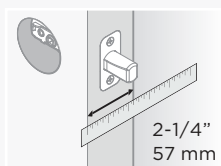

F (2x)

Call Kwikset to order a service kit for 2-1/4" (57 mm) thick doors. Use the screws provided in the kit.

11 Install deadbolt

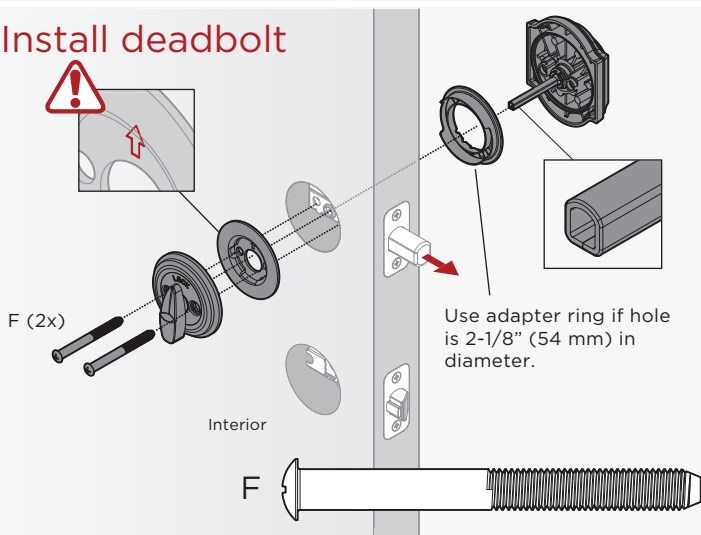

12 Install handleset

A

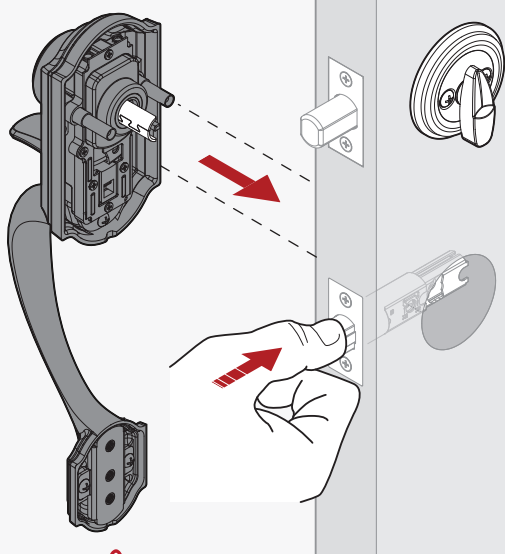

Press latch bolt in to insert the spindle. Insert the spindle into the semicircular hole in the bottom latch, and insert the bottom post through the bottom hole in the door.



If adjustment is required, pull and rotate spindle.

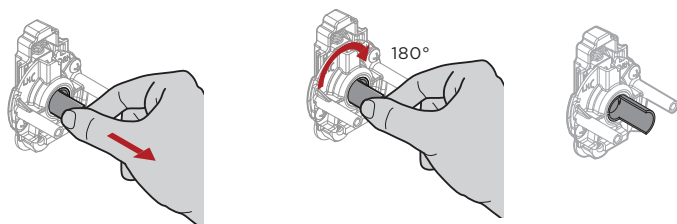

B

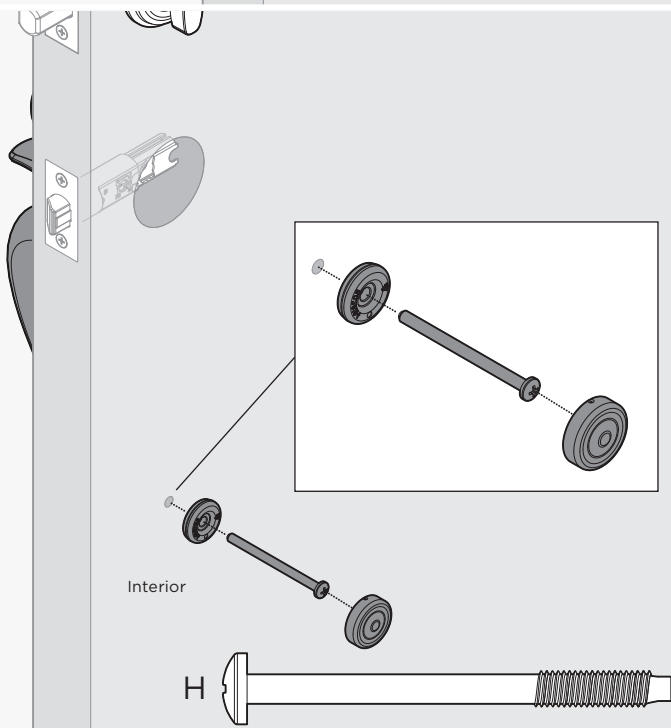

13 Install lever or knob

Option 1: Visible Screws

M



or

Option 2: Hidden Screws

M



A

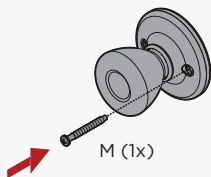

A

Loosen pre-installed set screws



B

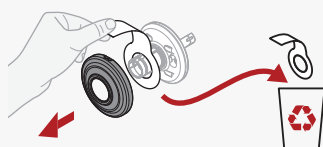

B

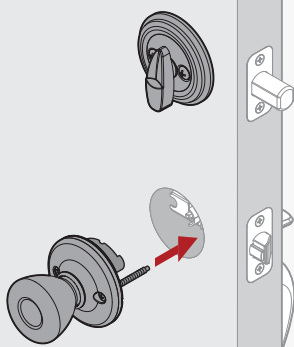

C

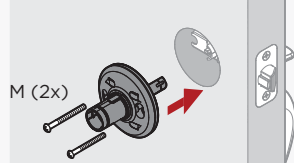

D

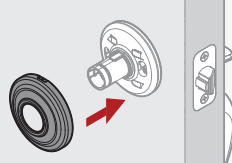

C

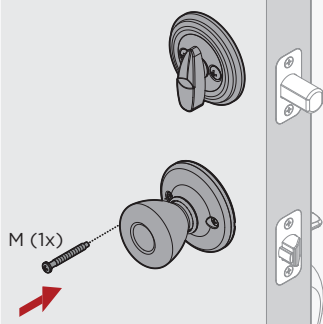

E

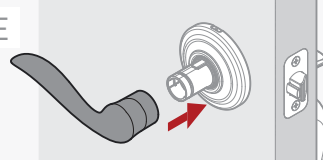

F

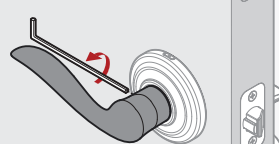

14 Install strike on door frame

A

⚠ Make sure hole in door frame is drilled a minimum of 1" (25 mm) deep.

Jamb

C (x2)

D (x2)

Longer screws install closest to jamb.

Note: The longer screws, 3" (76 mm) must be used to maintain highest security.

A (x2)

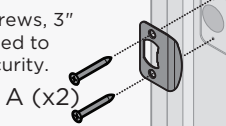

B

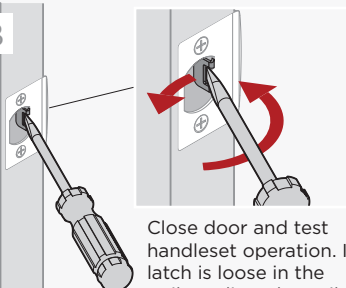

Close door and test handleset operation. If latch is loose in the strike, adjust the strike tab so it grips the latch better when the door is closed.

Installation instruction for the below designs



15 Determine deadbolt mounting screws

Measure the thickness of your door to determine the required mounting screws for step 16.

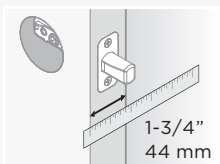

or

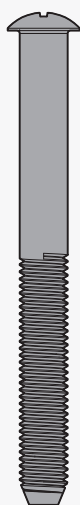
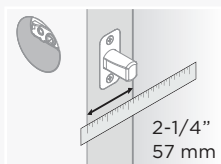

F (2x)

Call Kwikset to order a service kit for 2-1/4" (57 mm) thick doors. Use the screws provided in the kit.

16 Install deadbolt

A

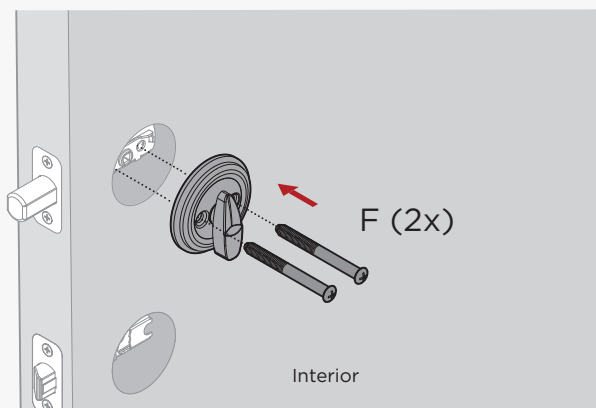

17 Install handleset

A

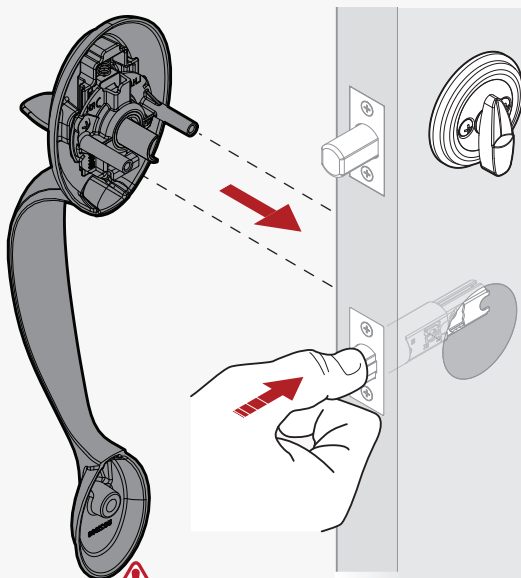

Press latch bolt in to insert the spindle. Insert the spindle into the semicircular hole in the bottom latch, and insert the bottom post through the bottom hole in the door.

⚠ If adjustment is required, pull and rotate spindle.

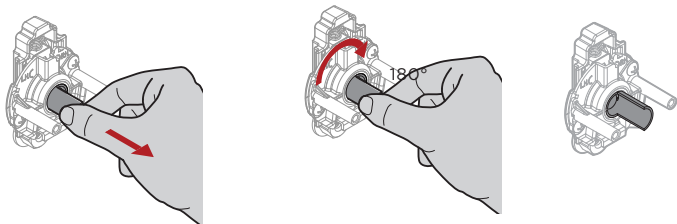

B

or

Wood door

If hole is drilled only partway through the door, use screw "I".



Metal door

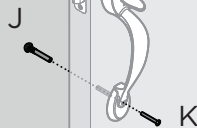

Wood door

If hole is drilled all the way through wood door, use screws "J" and "K".



Wood door

Pre-drilling is required. See drilling instructions if no pre-drilled holes exist.

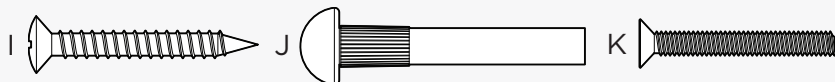
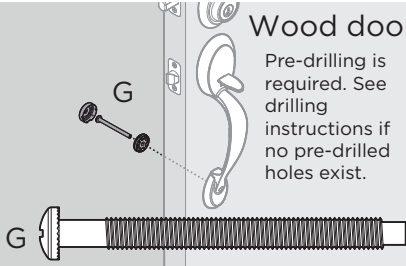

18 Install lever or knob

Option 1: Visible Screws



A

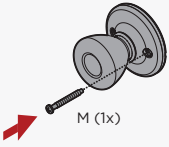

B

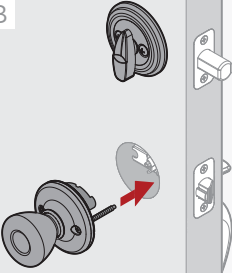

C

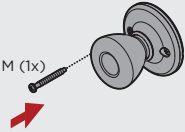

or

Option 2: Hidden Screws



A

Loosen pre-installed set screws



B



C

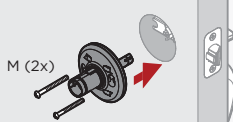

D



E



F



or

Option 3: Visible Screws

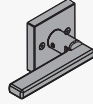

A

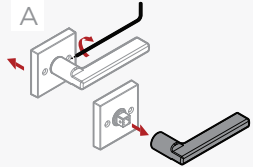

B

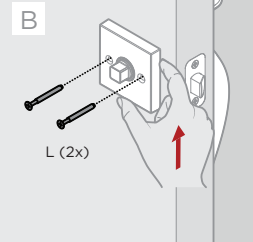

C

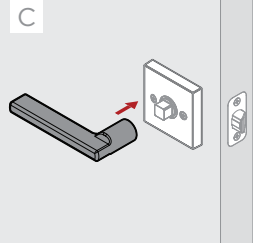

D

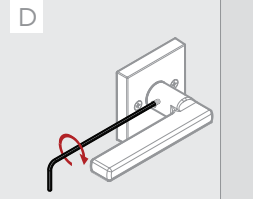

19 Install strike on door frame

A

⚠ Make sure hole in door frame is drilled a minimum of 1" (25 mm) deep.

Jamb

C (x2)

D (x2)

Longer screws install closest to jamb.

Note: The longer screws, 3" (76 mm) must be used to maintain highest security.

A (x2)

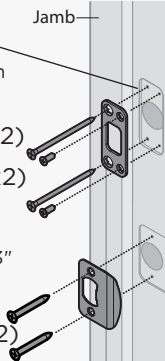

B

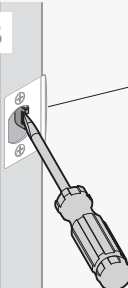

Close door and test handleset operation. If latch is loose in the strike, adjust the strike tab so it grips the latch better when the door is closed.

SmartKey Rekeying Instructions



SMARTKEY
SECURITY™

ONE KEY FOR ALL YOUR LOCKS™

The lock you can
re-key yourself in
seconds for any
situation, including:

Easily re-key
yourself

Reset tool
goes here



WITH PROTECTION AGAINST
ADVANCED BREAK-IN TECHNIQUES



**Recently
Moved**



**Lost
Keys**



**Multiple
Doors**



**Carry
Less Keys**

For rekeying instructions, you can also visit:

<https://www.kwikset.com/support/answers/how-to-re-key-your-smartkey-security-locks>

If you have any issues, please visit our
support center: [kwikset.com/support](https://www.kwikset.com/support)
or call us at 1-800-327-5625.



WARNING: This Manufacturer advises that no lock can provide complete security by itself. This lock may be defeated by forcible or technical means, or evaded by entry elsewhere on the property. No lock can substitute for caution, awareness of your environment, and common sense. Builder's hardware is available in multiple performance grades to suit the application. In order to enhance security and reduce risk, you should consult a qualified locksmith or other security professional.