

kēvo

Touch Sense Test

Perform the following test prior to installation to make sure your Kevo lock's touch sensor is working correctly.

- 1** Remove the exterior assembly, interior assembly and batteries from the package.

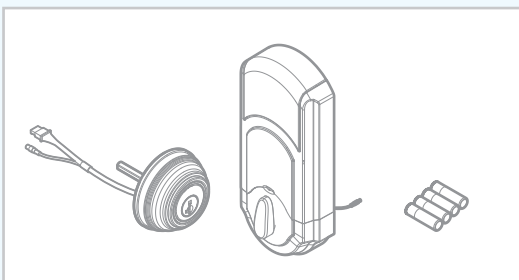

- 2** Remove the adapter ring from the exterior assembly and set it aside.

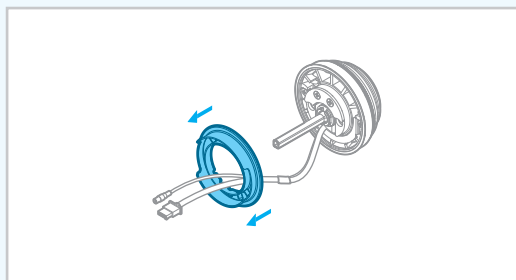

- 3** Remove the mounting plate, battery cover and battery pack from the interior assembly.

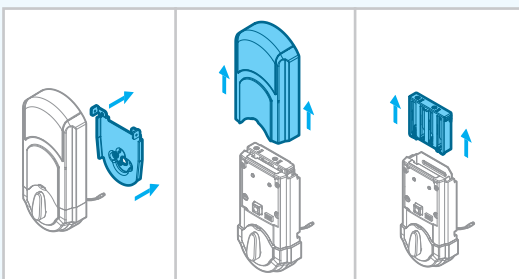

- 4** Install 4 AA batteries into the battery pack.

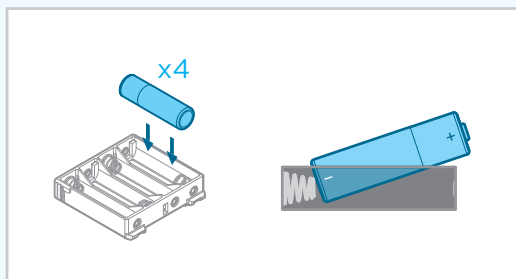

- 5** Lay the interior assembly on a flat surface, with the Kwikset label facing down.

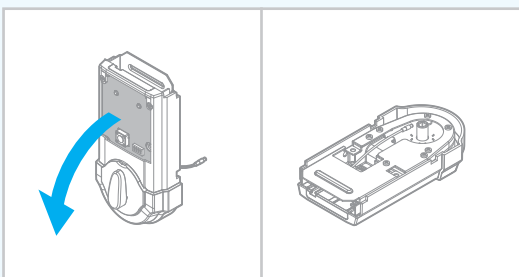

- 6** Connect the exterior assembly to the interior by inserting the exterior torque blade into the turnpiece shaft.

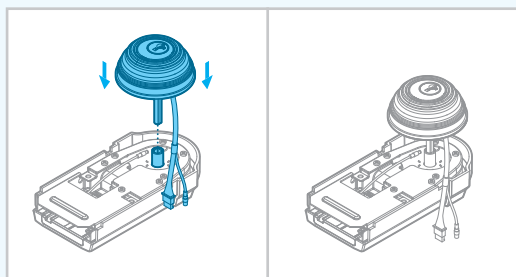

- 7 Connect the thinner cables together.

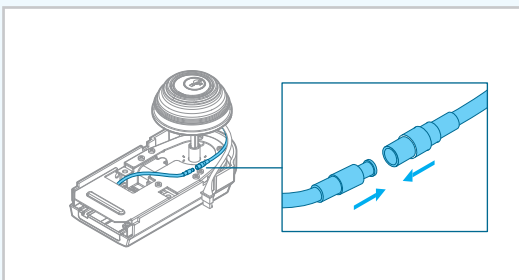

- 8 Insert the thicker cable into the square connector on the interior assembly.

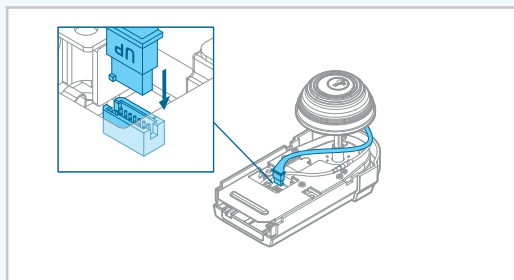

- 9 Insert the battery pack into the interior assembly. The light ring will spin amber during initialization.

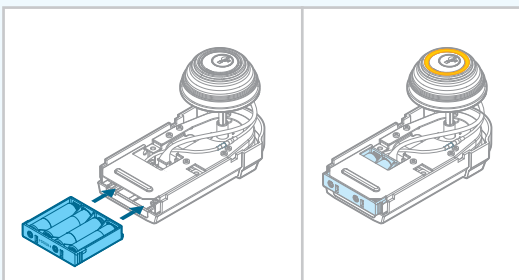

- 10 Wait about 10 seconds after initialization. Using one hand, gently touch the exterior deadbolt rose.

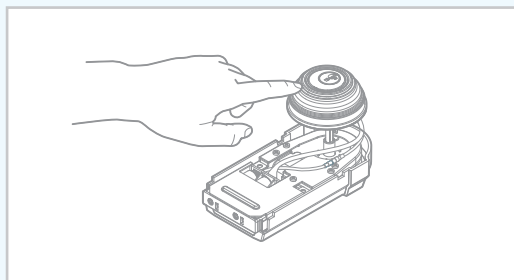

- 11 If you see the light ring spin blue, your Kevo's touch sensor is working properly, and you can disconnect the parts and install them on your door by following the Installation Guide.

IMPORTANT: Do not overtighten screws during installation.

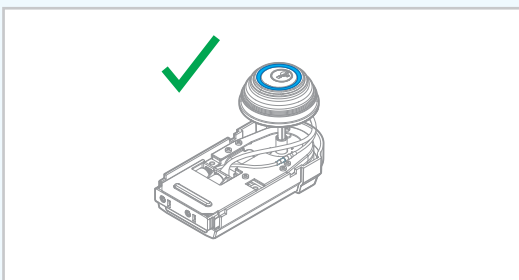

- 12 If you don't see the light ring spin blue, the touch sensor is not functioning properly. Please call Kevo Support at 1-877-543-3358.

